

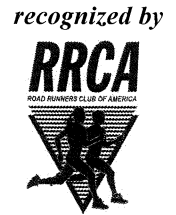

**Road Running Technical Council
USA Track & Field**

Measurement Certificate



Name of the course Splash N Dash 5K Distance 5 km
 Location (state) Mississippi (city) Oxford
 Type of course: road race calibration course track
 Measuring methods: bicycle steel tape electronic distance meter
 Measured by (name, address, phone & e-mail) Edward Dean email: eddean2008@yahoo.com
15 Edgarwood Road, Batesville, MS 38606 ph: (662) 609-9222
 Race contact (name, address, phone & e-mail) Marvin King email: marvin.p.king@gmail.com
115 Northgate, PMB # 1421, University, MS 38677 ph: (662) 715-9423
 Date(s) when course measured: 03/05/2016
 Number of measurements of entire course: 2 Course Configuration: complex of different loops
 Elevation (meters above sea level) Start 141 m Finish 140 m Highest 159 m Lowest 126 m
 Straight line distance between start & finish 115 m Drop 0.2 m/km Separation 2.3 %
 Type of surface: paved 100 % dirt _____ % gravel _____ % grass _____ % track _____ %
 Effective date of certification: 05/01/2016 Certification code: MS16006MS

Notice to Race Director: Use this Certification Code in **all** public announcements relating to your race.

Be It Officially Noted That

Based on examination of data provided by the above named measurer, the course described above and in the map attached is hereby certified as reasonably accurate in measurement according to the standards adopted by the Road Running Technical Council. If **any** changes are made to the course, this certification becomes void, and the course must then be recertified.

Verification of Course — In the event a National Open Record is set on this course, or at the discretion of USA Track & Field, a verification remeasurement may be required to be performed by a member of the Road Running Technical Council. If such a remeasurement shows the course to be short, then all pending records will be rejected and the course certification will be cancelled.

This certification expires on December 31 in the year **2026**

AS NATIONALLY CERTIFIED BY:

Matthew Studholme Date: 05/05/2016
 Matthew Studholme – USATF/RRTC Certifier
 452 Brookhill Drive, Abingdon, Virginia 24210 Phone: (276) 591-9242 E-mail: sheddingcat@comcast.net



Measured by: Edward Dean, 662-609-9222
 Email: eddean2008@yahoo.com
 Date of course measurement: March 5, 2016
 No Diagrams to scale

Splash N Dash 5k, Oxford, MS

- Notes:
1. Route measured with no restrictions. Runners have full road along shortest possible route.
 2. Start and finish are marked with P-K nails.
 3. Mile splits are marked with paint and are not certified points.



Not to Scale

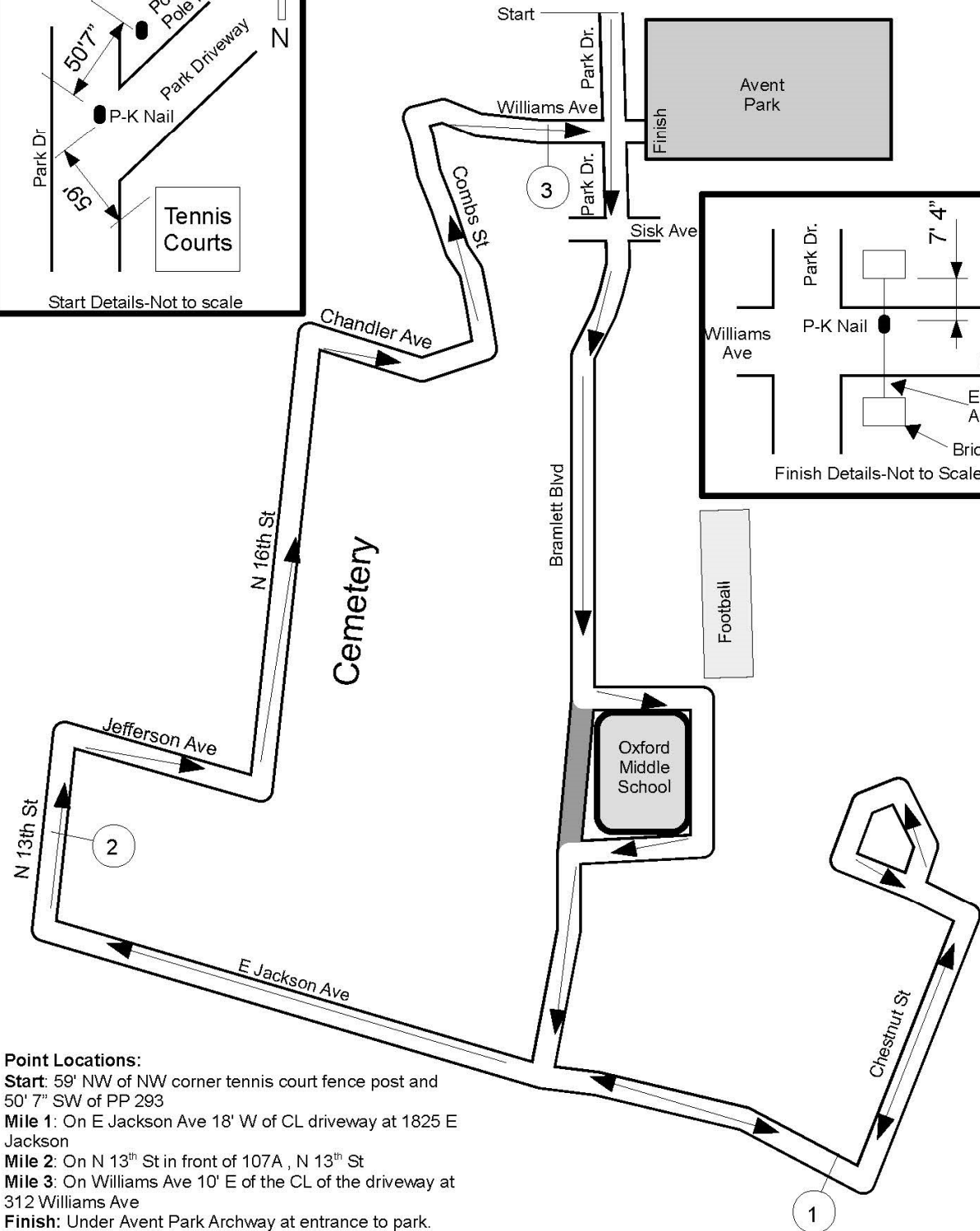
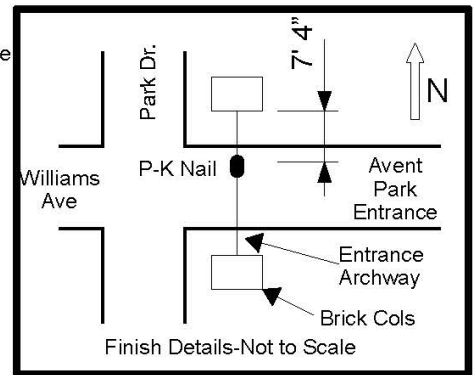
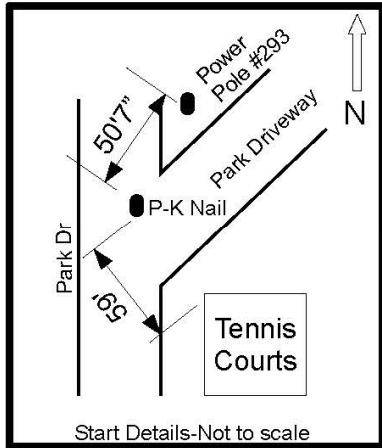

Point Locations:

- Start:** 59' NW of NW corner tennis court fence post and 50' 7" SW of PP 293
- Mile 1:** On E Jackson Ave 18' W of CL driveway at 1825 E Jackson
- Mile 2:** On N 13th St in front of 107A , N 13th St
- Mile 3:** On Williams Ave 10' E of the CL of the driveway at 312 Williams Ave
- Finish:** Under Avent Park Archway at entrance to park.